

Broadmeadow Way - Section 5

North Shore Of Malahide Estuary To R126 Hearse Road

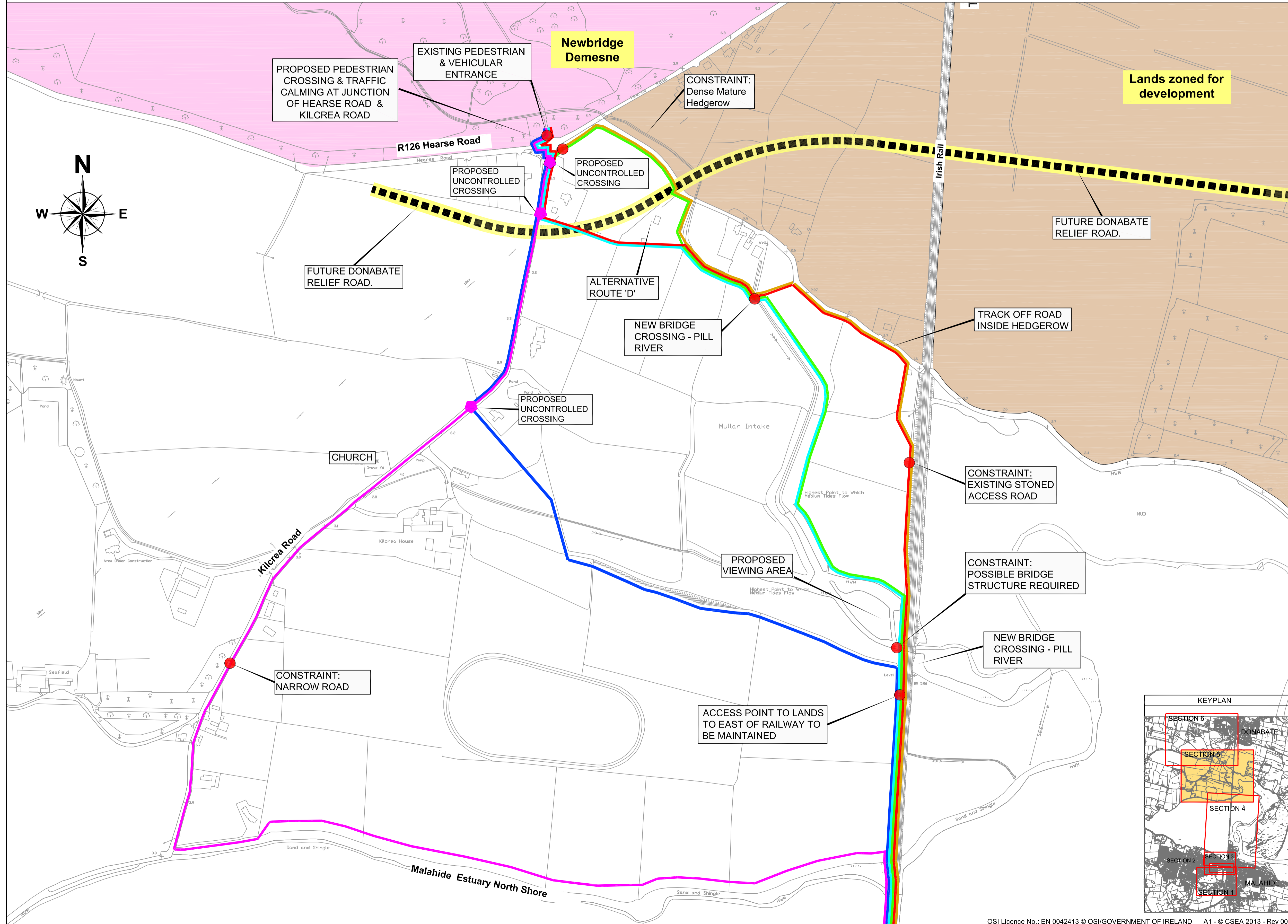

Legend:

- Section 5 Option 1: [Pink line]
- Section 5 Option 2: [Blue line]
- Section 5 Option 3: [Cyan line]
- Section 5 Option 4: [Green line]
- Section 5 Option 5: [Red line]
- Section 5 Option 6: [Yellow line]
- Future Road Network: [Dashed black line]
- Local Constraints: [Red dot]
- Crossings: [Purple pentagon]
- Lands Zoned (For Development): [Light brown area]
- Local Amenities (Newbridge Demesne): [Light pink area]

Clifton Scannell Emerson
Associates
Report
18/12/2013
CSEA

Revision	Description	Initials	Date

Clifton Scannell Emerson
Associates
Clifton Scannell Emerson Associates Limited
Consulting Engineers,
Seafort Lodge,
Castledawson Avenue,
Blackrock, Co. Dublin,
Ireland.
T. +353 1 288 5006
F. +353 1 283 3466
E. info@csea.ie
W. www.csea.ie

Client	Fingal County Council		
Project	Broadmeadow Way		
Dwg. Title	COMBINED ROUTE OPTIONS SECTION 5		
Drawn By	NH	Date	DECEMBER 2013
Checked by	NH	Scale	NTS @ A1
Dwg. Progress			
Dwg. No.	12_160_147		

